

LHCb Velo High Voltage Patch Panel (PP1)

Cut away for the 3pin lemo connector
EGG.1B.303.CLL

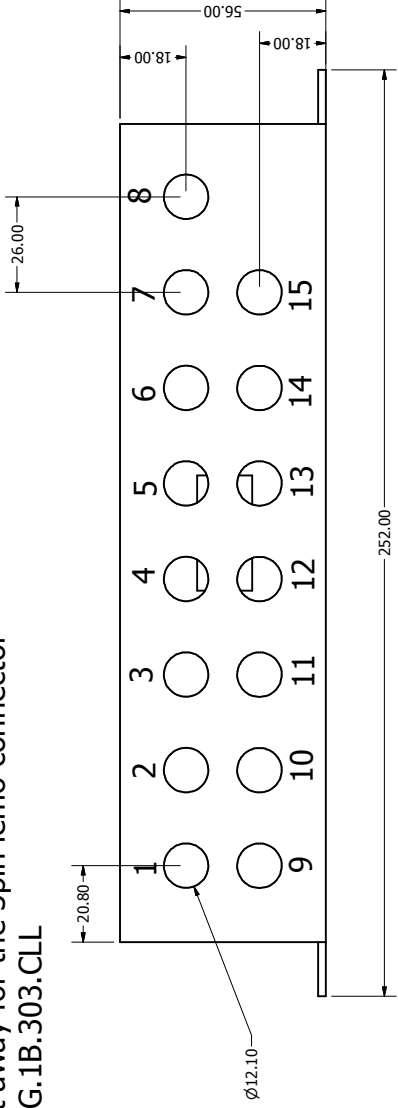

Side 1 (Modules)

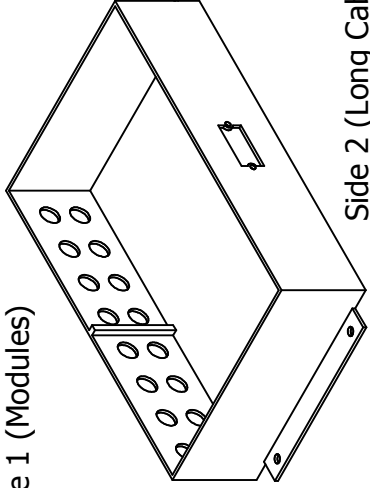

Side 2 (Long Cable)

Flanged Box Farnell SN 587643.
Wall thickness 2mm, includes lid.

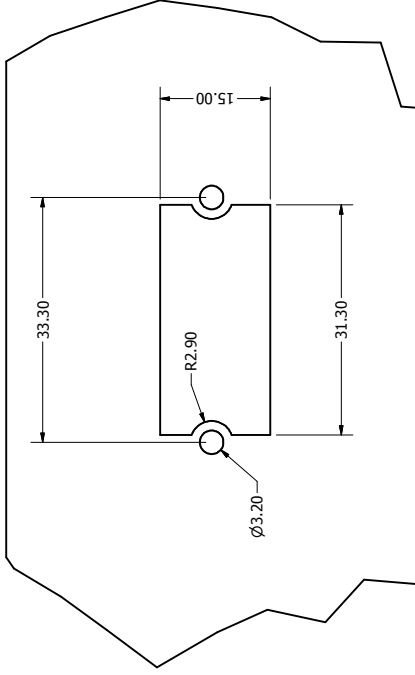

DETAIL A
SCALE 2 : 1

Cut Away for Lemo Redel S Series
51 pin connector (SLA.H51.LLL2G)
SCEM 09.41.34.268.7

| | | |
|--|------------|--------------------------------------|
| DRAWN | 20/03/2006 | Aldo F. Saavedra (LHCb VeLo Glasgow) |
| CHECKED | | |
| QA | | |
| MFG | | |
| APPROVED | | |
| TITLE | | |
| VeLo High Voltage Patch Panel (PP1) V1.2 (21-04-2006) | | |
| SIZE | DWG NO | REV |
| C | HV_box_PP1 | |
| SCALE | | |